

Fares

Urbandale On Call - cost per ride

Cash Fare	\$3.50
Children (Ages 6-10)	\$.75
Children 5 & Under	Free

(Must be accompanied by an adult)

Transfer (Regular to On Call) .	Transfer + \$1.75
Transfer (Express to On Call) .	Transfer + \$1.50
Express Plus Pass	Free
Monthly/Weekly Pass	Pass + \$1.75
Reduced Fare ID*	ID + \$.75
Reduced Fare* Express Plus Pass	Free
Reduced Fare* Monthly Pass	Pass + \$.75
Reduced Fare* Weekly Pass	Pass + \$.75
OTT Pass/Token	Pass/Token + \$1.75
Express Cash Fare	\$2.00

* Applies to Senior Citizens 65+, persons with disabilities, Medicare card holders and Veterans with a Service Connected ID.
 May be asked for additional identification to validate use/sale of reduced fares or passes. Additional forms of identification include a driver's license, Veterans Service Connected ID, or a photo ID presented with a Medicare Card, SSI Disability Card and DART Reduced Fare ID.

Please Remember: DART requires exact fares and all special ID's upon boarding.

#93 NW 86th ST. EXPRESS SCHEDULE

MORNING

INBOUND				OUTBOUND				
Leave	Johnston Dahl's & NW54th	Gloria Dei & Aurora	Clive Dahl's & Hickman	Arrive 9th & Pleasant	Arrive W 6th & Walnut	Arrive E 13th & Walnut	Clive Dahl's & Walnut & W 7th Hickman	Arrive Crescent Chase
5:48	5:50	5:57	6:01	6:20	6:25	6:33	6:06	6:22
6:36	6:38	6:45	6:49	7:10	7:15	7:23	6:37	6:53
7:13	7:15	7:22	7:26	7:47	7:52	8:00	7:32	7:48
8:06	8:08	8:13	8:17	8:35	8:40	8:48	---	---

AFTERNOON

OUTBOUND				INBOUND				
Leave	Penn & Grand	E. 13th & Walnut	W. 7th & Walnut	8th & Pleasant	Clive Dahl's & Hickman	Johnston 86th & Aurora	Arr/Lv Dahl's & Crescent NW 54th Chase	Walnut & W 6th
12:50	12:53	1:00	1:04	1:22	1:26	1:33	1:35/40	2:06
3:25	3:28	3:35	3:40	3:58	4:03	4:09	4:12/17	4:45
4:08	4:11	4:20	4:23	4:40	4:45	4:51	4:54/57	5:25
4:33	4:36	4:45	4:49	5:09	5:14	5:21	5:23/25	5:53
5:15	5:18	5:25	5:29	5:47	5:51	5:58	6:00/02	6:30

W - These trips connect with the #94 Westown Express at 22nd St. & Westown Parkway.
 All trips connect with the #3 University/Highland Oak Park at 22nd St. & Westown Parkway. See individual schedules for stop locations and times.
 ^ Passengers may board buses traveling to/from the garage. These buses may depart ahead of scheduled times.
 In the morning, bus travels to Gloria Dei shelter via Parkview, NW 82nd and Aurora. In the afternoon, bus stops on NW 86th at Aurora.

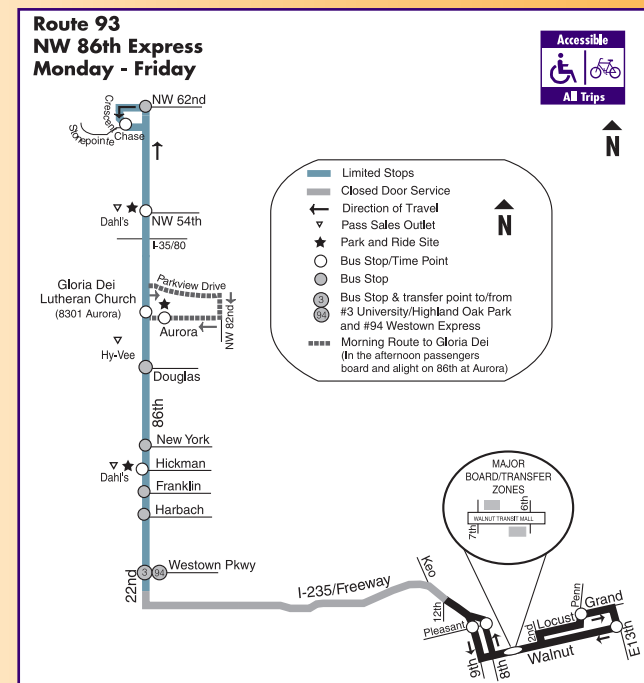

#92 URBANDALE EXPRESS SCHEDULE

MORNING

INBOUND			OUTBOUND					
Leave	Gloria Dei & Aurora	Ice Arena	Leave 9th & Pleasant	Arrive W. 6th & Walnut	Arrive E. 13th & Walnut	Leave W. 7th & Walnut	Leave Ice Arena	Arrive Gloria Dei & Aurora
5:51	6:01	6:15	6:20	6:28	6:35	6:58	7:07	
6:22	6:32	6:50	6:55	7:03	7:10	7:33	7:43	
7:13	7:26	7:45	7:50	7:58	---	---	---	
7:50	8:02	8:20	8:25	8:33	---	---	---	

AFTERNOON

OUTBOUND				INBOUND			
Leave	Penn & Grand	E. 13th & Walnut	W. 7th & Walnut	8th & Pleasant	Leave Ice Arena	Arr/Lv Gloria Dei & Aurora	Arrive W. 6th & Walnut
3:32	3:35	3:45	3:49	4:04	4:13/21	4:50	
4:23	4:26	4:35	4:39	4:58	5:09/13	5:43	
5:00	5:03	5:10	5:14	5:32	5:42/46	6:10	
5:35	5:38	5:45	5:48	6:04	6:13	---	

Bus does not make stops between Hickman & Westover and 12th & Keo.
 ^ Passengers may board buses traveling to/from the garage. These buses may depart ahead of scheduled times.

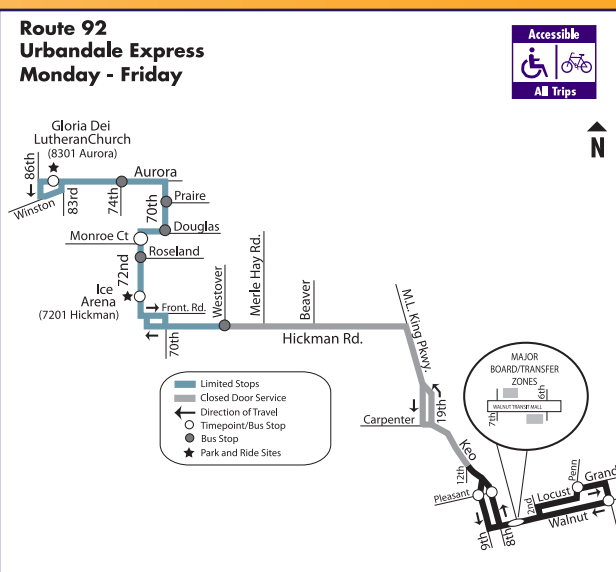

Des Moines Area Regional Transit Authority
 1100 DART Way, Des Moines, IA 50309
 515-283-8100 > ridedart.com > We'll Take You There!

Effective February 6, 2011

Urbandale On Call and Express Service



Service Monday - Friday

No Saturday, Sunday or Holiday Service



Des Moines Area Regional Transit Authority
 515-283-8100 > ridedart.com > We'll Take You There!

- You call us.**
283-8100
- We'll pick you up.**
Home or Office
- We'll take you there.**
Work, Shopping, Park & Ride to catch an Express or Local route bus, etc.
- Only \$3.50 per trip.**

For additional information about any DART service, please call 283-8100.

Urbandale On Call

Urbandale On Call is a neighborhood shuttle service. The shuttle can take you from a location near your home or workplace to the nearest transit stop or other destinations within the On Call service area.

DART's On Call service is one of the easiest forms of transportation available – as easy as calling a friend for a ride – *maybe easier*.

Service Area

- The Urbandale On Call service area is bounded by:
- North – NW 54th Ave. & I-35/80
 - South – University & Douglas Ave.
 - East – Merle Hay Road & NW 86th St.
 - West – 142nd St. & 86th St.

Please see map for your specific zone.

Days & Hours of Operation

Urbandale On Call service is available mornings and afternoons, **Monday thru Friday**, with no weekend or holiday service.

Morning pick-ups run from 5:45 am to 8:45 am, primarily to the Park & Rides at Wal-Mart at E. 1st St., Dahl's at 86th St. & NW 54th Ave. and Dahl's at 86th & Hickman Rd., Gloria Dei Lutheran Church at 84th & Aurora Ave., and the Metro Ice Arena at 72nd St. & Hickman Road.

Afternoon pick-ups run from 3:45 pm to 6:30 pm, primarily from the Park & Rides at Wal-Mart at E. 1st St., Dahl's at 86th St. & NW 54th Ave. and Dahl's at 86th & Hickman Rd., Gloria Dei Lutheran Church at 84th & Aurora Ave., and the Metro Ice Arena at 72nd St. & Hickman Road.

Trip Requests

You can schedule a ride by calling **283-8100**. Please be prepared to provide **your name, phone number, date of travel, departure location, destination and desired arrival time**. Service is available on a first-come, first-served basis. If you leave a message requesting an On Call trip, a DART On Call representative will call and confirm your trip.

Same-day trips can be made, on a space-available basis, by calling at least 30 minutes in advance. Trips may be scheduled up to 7 days in advance.

A Ride for Everyone

All DART On Call vehicles accommodate service animals and are wheelchair accessible. Adults must accompany children 5 & under.

Pick-Up Times

A DART On Call representative will review your request and schedule a pick-up time for your trip, although **vehicle arrival time may vary by up to 15 minutes**. Upon arrival, the driver will only wait 5 minutes for you to board.

Flexibility

On Call representatives will make every effort to accommodate your trip needs. During periods of high demand, your trip request may be more easily accommodated if you are willing to travel at a slightly different time or by a less-direct route to your destination.

Cancellations

To **cancel or change your trip reservation**, you must call **283-8100** at least 30 minutes prior to the scheduled pick-up, or a "no-show" will be recorded. More than 4 no-shows in a calendar month may result in a suspension of your On Call service.

On Call Zone Bus Phone Numbers

In requesting a trip you may call direct to the driver. Leave your name, phone number, date of travel, departure location, destination and desired arrival time and the driver will call you back. Same-day trips can be made, on a space-available basis, by calling at least 30 minutes in advance.

- Zone 1 -- 515-210-3979**
- Zone 2 -- 515-210-3635**
- Zone 3 -- 515-210-2873**
- Zone 4 -- 515-250-4057**

